

TEST PLUG VENT INSTALLATION INSTRUCTIONS

- **Curtiss-Wright Proprietary**

This document is the property of and contains information proprietary to Curtiss-Wright and/or its subcontractors and suppliers. It is transmitted to you in confidence and trust and is to be used solely for the purpose for which it is furnished, then returned upon request. You agree to treat this document in strict accordance with the terms and conditions of the agreement under which it was provided to you.

- **Export Compliance (EAR):**

EAR EXPORT CONTROLLED: *This document contains technology subject to the US Export Administration Regulations (EAR). Transfer of this data by any means to a foreign person or foreign entity, whether in the US or abroad may require a license from the US Department of Commerce. Diversion contrary to US law is prohibited. Violations of these export laws and regulations are subject to severe civil and criminal penalties.*

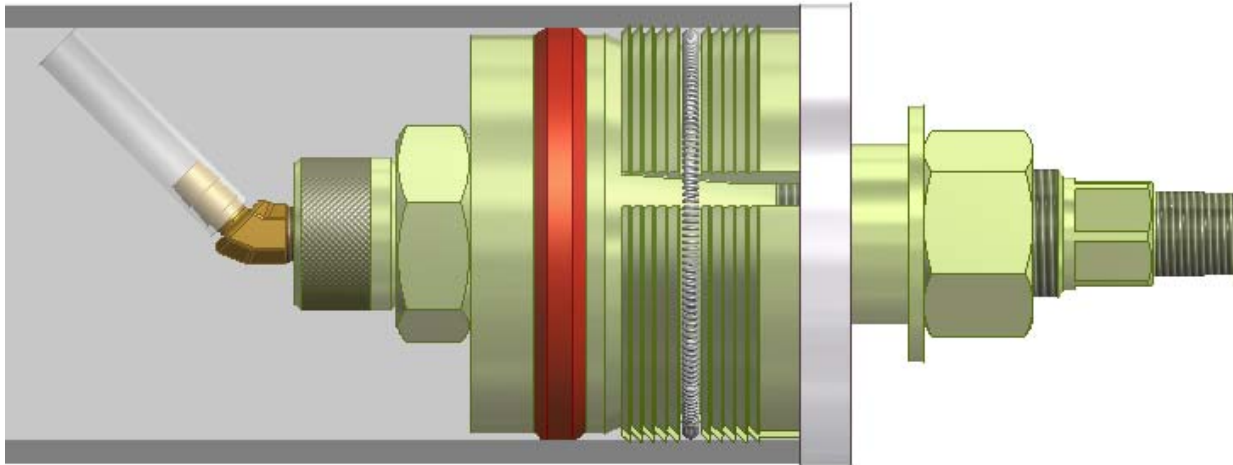

Figure 1 Single Shaft GT Vent Installation

INSTALLATION PROCEDURES:

1. Install vent assembly onto end of GripTight®, GTMAX®, or GT Elbow plug.
2. Hand tighten assembly onto test plug.
3. Trim tube length to be level with the plug OD and to fit into pipe.
4. Install test plug into pipe, per supplied instructions, with vent assembly pointing up as shown in Figure 1 to allow the maximum amount of gas to be removed from test setup.
5. Test in accordance with prescribed test protocol.

Questions? Contact EST Group Customer Service at any of the following locations.

**CURTISS -
WRIGHT**

EST Group
www.cw-estgroup.com

North, Central & South America

EST Group Corporate Office
2701 Township Line Road
Hatfield, PA 19440-1770 USA
P: +1.215.721.1100
+1.800.355.7044
F: +1.215.721.1101
est-info@curtisswright.com

Europe / Middle East / Africa

EST Group B.V.
Hoor 312a
2404 HL Alphen aan den Rijn
The Netherlands
P: +31.172.418841
F: +31.172.418849
est-emea@curtisswright.com

China

P +86.400.636.5077
est-china@curtisswright.cn

Singapore

P +65.3158.5052
est-asia@curtisswright.com

Vent to Plug Sizing Tables

GripTight Test Plugs

SALES NUMBER	PIPE SIZE	GT SHAFT SIZE
GTVC-0088	1 ¼ SCH 10 THRU 3 SCH XXS	7/8-14 UNF-2B
GTVC-0125	2 ½ SCH 40 THRU 4 SCH 10	1 1/4-12 UNF-2B
GTVC-0150	4 SCH 5 THRU 6 SCH 5	1 1/2-12 UNF-2B
GTVC-0075*	8 SCH 160 THRU 8 SCH 5	N/A

GripTightMAX Test Plugs

SALES NUMBER	PIPE SIZE	GTMAX SHAFT SIZE
GTVC-0088	1 ¼ SCH 10 THRU 3 SCH XXS	7/8-14 UNF-2B
GTVC-0125	2 ½ SCH 40 THRU 4 SCH 10	1 1/4-12 UNF-2B
GTVC-0150	4 SCH 5 THRU 5 SCH 80	1 1/2-12 UNF-2B
GTVC-0075*	6 SCH XXS THRU 10 SCH 120	N/A

GripTight Elbow Test Plugs

SALES NUMBER	PIPE SIZE	GT ELBOW SHAFT SIZE
GTVC-0070	2 SCH 80 THRU 2 ½ SCH 80	3/4-16 UNF-2B
GTVC-0113	2 ½ SCH 40 THRU 4 SCH 10	1 1/8-12 UNF-2B
GTVC-0125	4 SCH 5 THRU 5 SCH 80	1 1/4-12 UNF-2B
GTVC-0075*	6 SCH XXS THRU 10 SCH 120	N/A

*Note: Plugs made with castings after 2017 have integrated vents.

Questions? Contact EST Group Customer Service at any of the following locations.

**CURTISS -
WRIGHT**

EST Group
www.cw-estgroup.com

North, Central & South America

EST Group Corporate Office
2701 Township Line Road
Hatfield, PA 19440-1770 USA
P: +1.215.721.1100
+1.800.355.7044
F: +1.215.721.1101
est-info@curtisswright.com

Europe / Middle East / Africa

EST Group B.V.
Hoorn 312a
2404 HL Alphen aan den Rijn
The Netherlands
P: +31.172.418841
F: +31.172.418849
est-emea@curtisswright.com

China

P +86.400.636.5077
est-china@curtisswright.cn

Singapore

P +65.3158.5052
est-asia@curtisswright.com